

GT 5MGT
Delning 5 mm

St = Stål
Alu = Aluminium
● = Med fläns
○ = Utan fläns

Beställningsexempel:
5MGT 21 25 F Kuggremskiva PGGT

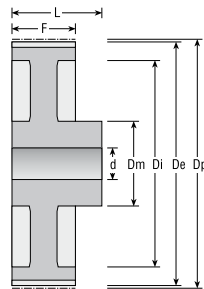
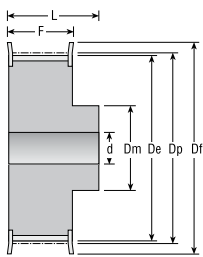

Figur 6F

Figur 6W

Viktig information!

Kuggremskiva 5MGT passar till
kuggrem PowerGrip GT3 5MGT och
Poly Chain Carbon 5MGT

Kugg- antal Z	Rem- bredd	Mat.	Fig.	Delning Ø Dp	Ytter Ø De	Fläns Ø Df	Nav Ø Dm	Di	F	L	För- bör- d	Max axelhål	Vikt kg	
12	●	9	St	6F	19,10	17,96	23,0	13,0	-	14,5	20,0	4,0	8	0,028
12	●	15	St	6F	19,10	17,96	23,0	13,0	-	20,5	26,0	4,0	8	0,034
12	●	25	St	6F	19,10	17,96	23,0	13,0	-	30,5	36,0	4,0	8	0,050
14	●	9	St	6F	22,28	21,14	25,0	13,0	-	14,5	20,0	6,0	8	0,034
14	●	15	St	6F	22,28	21,14	25,0	13,0	-	20,5	26,0	6,0	8	0,046
14	●	25	St	6F	22,28	21,14	25,0	13,0	-	30,5	36,0	6,0	8	0,070
15	●	9	St	6F	23,87	22,73	28,0	16,0	-	14,5	20,0	6,0	10	0,042
15	●	15	St	6F	23,87	22,73	28,0	16,0	-	20,5	26,0	6,0	10	0,056
15	●	25	St	6F	23,87	22,73	28,0	16,0	-	30,5	36,0	6,0	10	0,080
16	●	9	St	6F	25,46	24,32	28,0	16,0	-	14,5	20,0	6,0	10	0,050
16	●	15	St	6F	25,46	24,32	28,0	16,0	-	20,5	26,0	6,0	10	0,064
16	●	25	St	6F	25,46	24,32	28,0	16,0	-	30,5	36,0	6,0	10	0,100
18	●	9	St	6F	28,65	27,51	32,0	19,0	-	14,5	20,0	6,0	12	0,070
18	●	15	St	6F	28,65	27,51	32,0	19,0	-	20,5	26,0	6,0	12	0,086
18	●	25	St	6F	28,65	27,51	32,0	19,0	-	30,5	36,0	6,0	12	0,120
20	●	9	St	6F	31,83	30,69	36,0	23,0	-	14,5	22,5	6,0	14	0,094
20	●	15	St	6F	31,83	30,69	36,0	23,0	-	20,5	26,0	6,0	14	0,112
20	●	25	St	6F	31,83	30,69	36,0	23,0	-	30,5	36,0	6,0	14	0,160
21	●	9	St	6F	33,42	32,28	38,0	24,0	-	14,5	22,5	6,0	15	0,110
21	●	15	St	6F	33,42	32,28	38,0	24,0	-	20,5	26,0	6,0	15	0,130
21	●	25	St	6F	33,42	32,28	38,0	24,0	-	30,5	38,0	6,0	15	0,190
22	●	9	St	6F	35,01	33,87	38,0	25,5	-	14,5	22,5	6,0	16	0,118
22	●	15	St	6F	35,01	33,87	38,0	25,5	-	20,5	26,0	6,0	16	0,140
22	●	25	St	6F	35,01	33,87	38,0	25,5	-	30,5	38,0	6,0	16	0,210
24	●	9	St	6F	38,20	37,06	42,0	27,0	-	14,5	22,5	6,0	17	0,145
24	●	15	St	6F	38,20	37,06	42,0	27,0	-	20,5	28,0	6,0	17	0,180
24	●	25	St	6F	38,20	37,06	42,0	27,0	-	30,5	38,0	6,0	17	0,250
26	●	9	St	6F	41,38	40,24	44,0	30,0	-	14,5	22,5	6,0	19	0,170
26	●	15	St	6F	41,38	40,24	44,0	30,0	-	20,5	28,0	6,0	19	0,220
26	●	25	St	6F	41,38	40,24	44,0	30,0	-	30,5	38,0	6,0	19	0,300
28	●	9	St	6F	44,56	43,42	48,0	30,5	-	14,5	22,5	6,0	19	0,200
28	●	15	St	6F	44,56	43,42	48,0	30,5	-	20,5	28,0	6,0	19	0,250
28	●	25	St	6F	44,56	43,42	48,0	30,5	-	30,5	38,0	6,0	19	0,350
30	●	9	St	6F	47,75	46,60	51,0	35,0	-	14,5	22,5	6,0	21	0,236
30	●	15	St	6F	47,75	46,60	51,0	35,0	-	20,5	28,0	6,0	21	0,300
30	●	25	St	6F	47,75	46,60	51,0	35,0	-	30,5	38,0	6,0	21	0,420
32	●	9	St	6F	50,93	49,79	54,0	38,0	-	14,5	22,5	8,0	24	0,270
32	●	15	St	6F	50,93	49,79	54,0	38,0	-	20,5	28,0	8,0	24	0,350
32	●	25	St	6F	50,93	49,79	54,0	38,0	-	30,5	38,0	8,0	24	0,480
36	●	9	St	6F	57,30	56,16	60,0	38,0	-	14,5	22,5	8,0	24	0,324
36	●	15	St	6F	57,30	56,16	60,0	38,0	-	20,5	28,0	8,0	24	0,426
36	●	25	St	6F	57,30	56,16	60,0	38,0	-	30,5	38,0	8,0	24	0,590

Kugg- antal Z	Rem- bredd	Mat.	Fig.	Delning Ø Dp	Ytter Ø De	Fläns Ø Df	Nav Ø Dm	Di	F	L	För- borr. d	Max axelhål	Vikt kg	
40	●	9	St	6F	63,66	62,52	71,0	38,0	-	14,5	22,5	8,0	24	0,400
40	●	15	St	6F	63,66	62,52	71,0	38,0	-	20,5	28,0	8,0	24	0,520
40	●	25	St	6F	63,66	62,52	71,0	38,0	-	30,5	38,0	8,0	24	0,740
44	○	9	Alu	6W	70,03	68,89	-	38,0	-	14,5	25,5	8,0	24	0,170
44	○	15	Alu	6W	70,03	68,89	-	38,0	-	20,5	30,0	8,0	24	0,187
44	○	25	Alu	6W	70,03	68,89	-	38,0	-	30,5	40,0	8,0	24	0,320
48	○	9	Alu	6W	76,39	75,25	-	45,0	-	14,5	25,5	8,0	28	0,182
48	○	15	Alu	6W	76,39	75,25	-	38,0	-	20,5	30,0	8,0	24	0,225
48	○	25	Alu	6W	76,39	75,25	-	38,0	-	30,5	40,0	8,0	24	0,275
60	○	9	Alu	6W	95,49	94,35	-	45,0	-	14,5	25,5	8,0	28	0,230
60	○	15	Alu	6W	95,49	94,35	-	50,0	-	20,5	30,0	8,0	32	0,305
60	○	25	Alu	6W	95,49	94,35	-	50,0	-	30,5	40,0	8,0	32	0,435
72	○	9	Alu	6W	114,59	113,45	-	45,0	-	14,5	25,5	8,0	28	0,270
72	○	15	Alu	6W	114,59	113,45	-	50,0	-	20,5	30,0	8,0	32	0,375
72	○	25	Alu	6W	114,59	113,45	-	50,0	-	30,5	40,0	8,0	32	0,525