

GT 8MGT / HTD 8M
Delning 8 mm

St = Stål
Gj = Gjutjärn
● = Med fläns
○ = Utan fläns

Beställningsexempel:
8M 24 20 F Kuggremskiva HTD fast nav

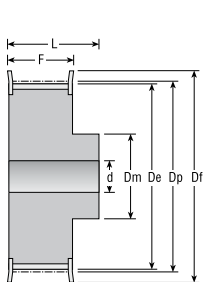

Figur 6F

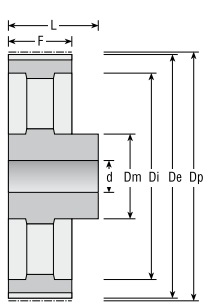

Figur 6A

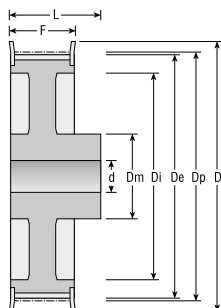

Figur 6WF

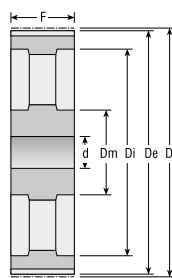

Figur 10A

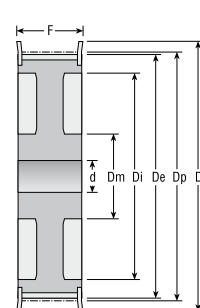

Figur 10WF

Kugg- antal Z	Rem- bredd	Mat.	Fig.	Delning Ø Dp	Ytter Ø De	Fläns Ø Df	Nav Ø Dm	Di	F	L	För- bör- d	Max axelhål	Vikt kg	
22	●	20	St	6F	56,02	54,65	60	43	-	28	38	12	26	0,54
22	●	30	St	6F	56,02	54,65	60	43	-	38	48	12	26	0,69
22	●	50	St	6F	56,02	54,65	60	43	-	60	70	12	26	1,00
22	●	85	St	6F	56,02	54,65	60	43	-	95	105	12	26	1,55
24	●	20	St	6F	61,12	59,75	66	45	-	28	38	12	28	0,65
24	●	30	St	6F	61,12	59,75	66	45	-	38	48	12	28	0,84
24	●	50	St	6F	61,12	59,75	66	45	-	60	70	12	28	1,23
24	●	85	St	6F	61,12	59,75	66	45	-	95	105	12	28	1,90
26	●	20	St	6F	66,21	64,84	71	50	-	28	38	12	32	0,80
26	●	30	St	6F	66,21	64,84	71	50	-	38	48	12	32	1,00
26	●	50	St	6F	66,21	64,84	71	50	-	60	70	12	32	1,50
26	●	85	St	6F	66,21	64,84	71	50	-	95	105	12	32	2,25
28	●	20	St	6F	71,30	70,08	75	50	-	28	38	15	32	0,87
28	●	30	St	6F	71,30	70,08	75	50	-	38	48	15	32	1,12
28	●	50	St	6F	71,30	70,08	75	50	-	60	70	15	32	1,67
28	●	85	St	6F	71,30	70,08	75	50	-	95	105	15	32	2,55
30	●	20	St	6F	76,39	75,13	83	55	-	28	38	15	35	1,02
30	●	30	St	6F	76,39	75,13	83	55	-	38	48	15	35	1,32
30	●	50	St	6F	76,39	75,13	83	55	-	60	70	15	35	1,97
30	●	85	St	6F	76,39	75,13	83	55	-	95	105	15	35	3,00
32	●	20	St	6F	81,49	80,16	87	60	-	28	38	15	42	1,20
32	●	30	St	6F	81,49	80,16	87	60	-	38	48	15	42	1,53
32	●	50	St	6F	81,49	80,16	87	60	-	60	70	15	42	2,27
32	●	85	St	6F	81,49	80,16	87	60	-	95	105	15	42	3,57
34	●	20	St	6F	86,58	85,22	91	70	-	28	38	15	45	1,40
34	●	30	St	6F	86,58	85,22	91	70	-	38	48	15	45	1,80
34	●	50	St	6F	86,58	85,22	91	70	-	60	70	15	45	2,69
34	●	85	St	6F	86,58	85,22	91	70	-	95	105	15	45	4,00
36	●	20	St	6F	91,67	90,30	98	70	-	28	38	15	45	1,55
36	●	30	St	6F	91,67	90,30	98	70	-	38	48	15	45	1,99
36	●	50	St	6F	91,67	90,30	98	70	-	60	70	15	45	2,97
36	●	85	St	6F	91,67	90,30	98	70	-	95	105	15	45	4,50
38	●	20	St	6F	96,77	95,39	103	75	-	28	38	15	48	1,65
38	●	30	St	6F	96,77	95,39	103	75	-	38	48	15	48	2,27
38	●	50	St	6F	96,77	95,39	103	75	-	60	70	15	48	3,23
38	●	85	St	6F	96,77	95,39	103	75	-	95	105	15	48	4,90
40	●	20	Gj	6F	101,86	100,49	106	75	-	28	38	15	48	1,74
40	●	30	Gj	6F	101,86	100,49	106	75	-	38	48	15	48	2,40
40	●	50	Gj	6F	101,86	100,49	106	75	-	60	70	18	48	3,50
40	●	85	Gj	6F	101,86	100,49	106	75	-	95	105	18	48	5,20
44	●	20	Gj	6F	112,05	110,67	119	75	-	28	38	15	48	2,10
44	●	30	Gj	6F	112,05	110,67	119	75	-	38	48	15	48	2,80
44	●	50	Gj	6F	112,05	110,67	119	75	-	60	70	18	48	3,90
44	●	85	Gj	6F	112,05	110,67	119	75	-	95	105	18	48	6,60

Viktig information!

Kuggremskiva HTD 8M passar även till
kuggrem PowerGrip GT3 8MGT samt
PowerGrip GTX 8MX

Kugg- antal Z	Rem- bredd	Mat.	Fig.	Delning Ø Dp	Ytter Ø De	Fläns Ø Df	Nav Ø Dm	Di	F	L	För- borr. d	Max axelhål	Vikt kg	
48	•	20	Gj	6F	122,23	120,86	127	75	-	28	38	15	48	2,44
48	•	30	Gj	6F	122,23	120,86	127	75	-	38	48	15	48	3,20
48	•	50	Gj	6F	122,23	120,86	127	80	-	60	70	18	50	4,30
48	•	85	Gj	6F	122,23	120,86	127	80	-	95	105	18	50	7,60
56	•	20	Gj	6WF	142,60	141,23	148	80	117	28	38	15	50	2,60
56	•	30	Gj	6WF	142,60	141,23	148	90	117	38	48	15	55	3,60
56	•	50	Gj	10WF	142,60	141,23	148	90	117	60	60	18	55	5,00
56	•	85	Gj	6F	142,60	141,23	148	80	-	95	105	20	50	9,80
64	•	20	Gj	6WF	162,97	161,60	168	80	137	28	38	15	50	2,90
64	•	30	Gj	6WF	162,97	161,60	168	90	137	38	48	15	55	4,30
64	•	50	Gj	10WF	162,97	161,60	168	100	137	60	60	18	65	5,60
64	•	85	Gj	10WF	162,97	161,60	168	100	137	95	95	20	65	10,40
72	•	20	Gj	6WF	183,35	181,97	192	80	158	28	38	15	50	3,10
72	•	30	Gj	6WF	183,35	181,97	192	95	158	38	48	15	60	4,80
72	•	50	Gj	10WF	183,35	181,97	192	100	158	60	60	18	65	6,80
72	•	85	Gj	10WF	183,35	181,97	192	110	158	95	95	20	70	11,40
80	○	20	Gj	6A	203,72	202,35	-	90	180	28	38	15	55	3,80
80	○	30	Gj	6A	203,72	202,35	-	100	180	38	48	15	65	5,10
80	○	50	Gj	10A	203,72	202,35	-	110	180	60	60	18	70	6,90
80	○	85	Gj	10A	203,72	202,35	-	110	180	95	95	20	70	11,10
90	○	20	Gj	6A	229,18	227,81	-	90	204	28	38	15	55	4,20
90	○	30	Gj	6A	229,18	227,81	-	100	204	38	48	15	65	5,70
90	○	50	Gj	10A	229,18	227,81	-	110	204	60	60	18	70	8,60
90	○	85	Gj	10A	229,18	227,81	-	110	204	95	95	20	70	13,20
112	○	20	Gj	6A	285,21	283,83	-	90	260	28	38	18	55	5,20
112	○	30	Gj	6A	285,21	283,83	-	100	260	38	48	18	65	6,80
112	○	50	Gj	10A	285,21	283,83	-	110	260	60	60	18	70	9,60
112	○	85	Gj	10A	285,21	283,83	-	110	260	95	95	24	70	16,30
144	○	20	Gj	6A	366,69	365,32	-	90	341	28	38	20	55	7,50
144	○	30	Gj	6A	366,69	365,32	-	100	341	38	48	20	65	9,30
144	○	50	Gj	10A	366,69	365,32	-	110	341	60	60	20	70	13,80
144	○	85	Gj	10A	366,69	365,32	-	120	341	95	95	24	75	21,50
168	○	20	Gj	6A	427,81	426,44	-	100	402	28	38	20	65	10,00
168	○	30	Gj	6A	427,81	426,44	-	100	402	38	48	20	65	11,40
168	○	50	Gj	10A	427,81	426,44	-	120	402	60	60	20	75	16,00
168	○	85	Gj	10A	427,81	426,44	-	120	402	95	95	24	75	26,10
192	○	20	Gj	6A	488,92	487,55	-	100	463	28	38	20	65	14,40
192	○	30	Gj	6A	488,92	487,55	-	100	463	38	48	20	65	16,00
192	○	50	Gj	10A	488,92	487,55	-	130	463	60	60	20	80	22,40
192	○	85	Gj	10A	488,92	487,55	-	130	463	95	95	24	80	30,60